

# MODEL RAIL UK

## Colour light Instructions for Single Packets CLSP1

The information below shows the wiring used with the terminal blocks and with the addition of switches you are able to operate them. (See over) You will need solder and soldering iron plus a small terminal screwdriver. Ensure your wiring is insulated to prevent shorting. Contents. Coloured light, (1) Terminal Block, (1 or 2) foam pads, cast diamond and phone box. We also offer the following:- 3 coloured lights in a pack together with a control PCB which will run 2,3 & 4 aspect lights. This comes complete with switches and full instructions.

Colour Control PCB 501-320

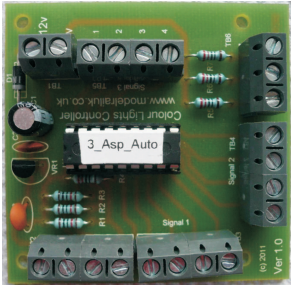

2 & 4 aspect signal showing connections

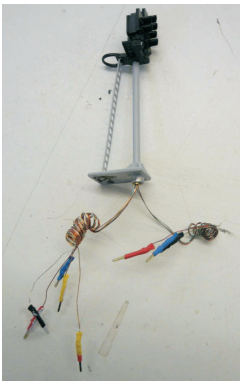

To switch wiring or power supply

To the negative (-ve) 12v D.C.  
To the positive (+ve) 12v D.C.

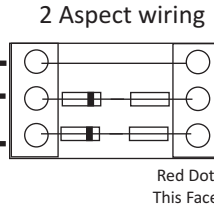

To colour lights. Wire and Sleeve colours

SILVER with BLACK Sleeve.  
GREEN with BLUE Sleeve.  
RED with RED Sleeve

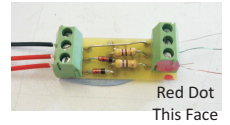

To the negative (-ve) 12v D.C.  
To the positive (+ve) 12v D.C.

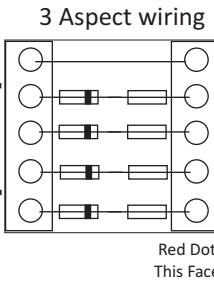

SILVER with BLACK Sleeve.  
YELLOW with YELLOW Sleeve.  
GREEN with BLUE Sleeve.  
RED with RED Sleeve

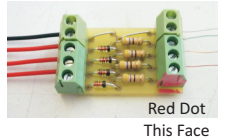

To the negative (-ve) 12v D.C.  
To the positive (+ve) 12v D.C.

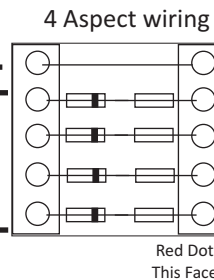

SILVER with BLACK Sleeve.  
YELLOW with YELLOW Sleeve.  
GREEN with BLUE Sleeve.  
RED with RED Sleeve  
YELLOW with YELLOW Sleeve  
This second led part marked Red.

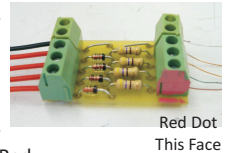

***Sleeve marking. When using 4 aspect then second yellow will be part marked with Red. When wiring up junctions one set of wiring is part marked with White.***

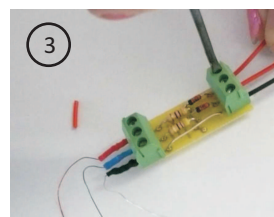
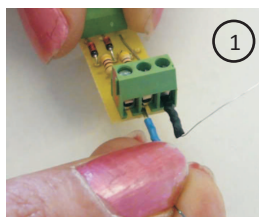

Connecting your light to the terminal block and applying the doubled sided foam tape to attach block underside of baseboard

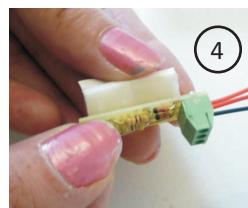
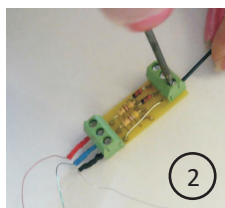

Model Rail U.K. Also manufacture these switch assemblies on a face plate with screw terminal connectors for easy assembly. Please contact us for details.

**Model Rail UK, 45a Darracott Road, Bournemouth, Dorset BH5 2AY.  
Tel: 01202 434495 Fax: 01202 421016**

Below are a couple ideas to assist you in making your own switching panel using parts obtained from Maplin or similar.

You can use the Terminal board where these components are used. Just ensure you observe the polarity of the Diodes. Terminal board is shown by the dotted line.

Wiring up a 4 pole 3 way switch to a 2 aspect head

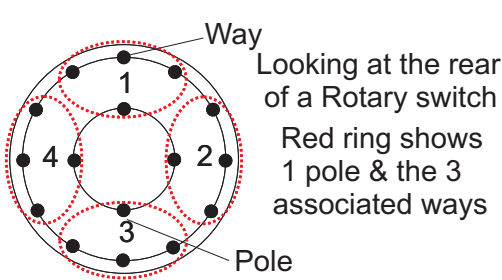
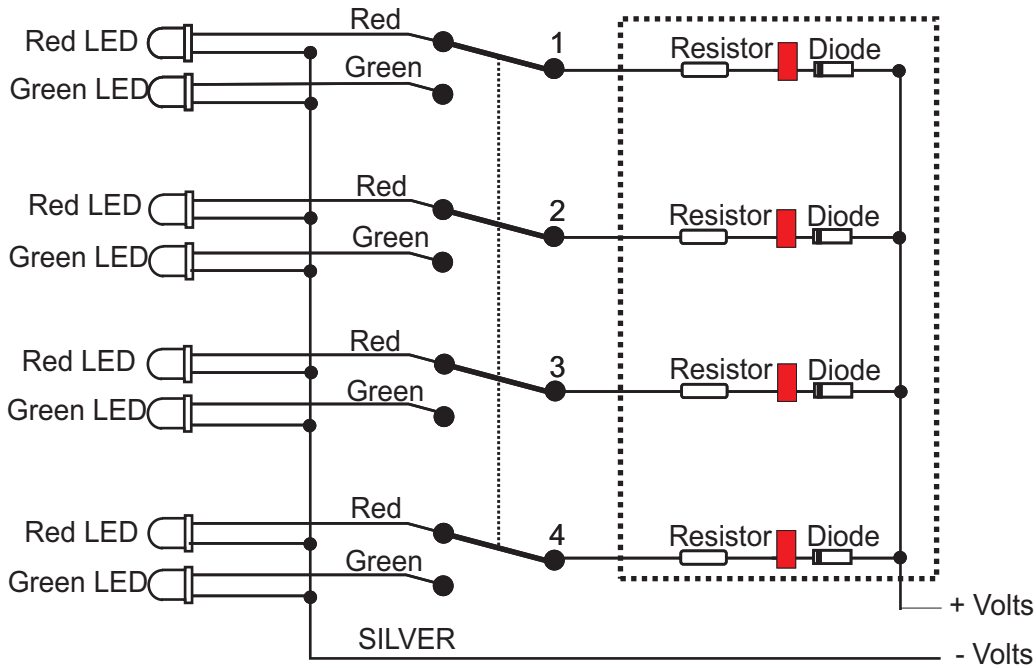

Looking at the rear of a Rotary switch  
 Red ring shows 1 pole & the 3 associated ways

Wiring Information For 12 V D.C. OR 16 V A.C.  
 Solder Resistor To End Of Diode Marked With Black Ring And Red Tape. (See Fig 1).  
 Solder Resistor To The pole position tag.  
 Connect Other End Of Diode (No Tape) To Supply.

Using a single pole double throw toggle switch to operate 2 aspect colour light

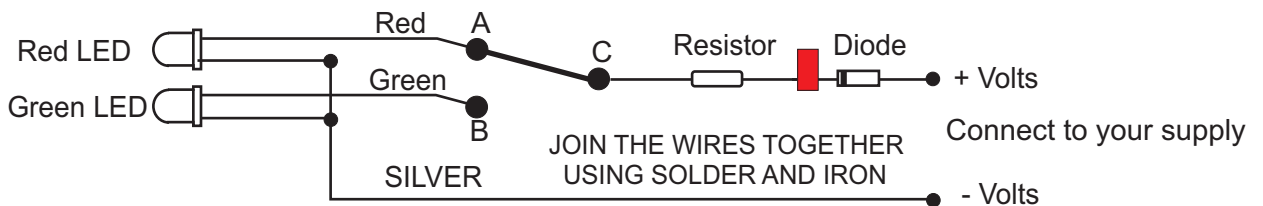

Using a double pole double throw toggle switch to operate 2 x 2 aspect colour lights

